

P/N 20848-129 FURNISHED AS A KIT
PCB w/MICROSWITCH NOT INCLUDED

TOLERANCE (UNLESS OTHERWISE SPECIFIED)			
mm	HOLES	[INCH]	HOLES
DECIMALS	0.00 +.08	DECIMALS	0.000 +.003
X	3.19 -.03	X.XX	.124 -.001
X.X	3.20 +.10	X.XXX	.125 +.004
X.XX	6.39 -.03		.250 -.001
X.XX	6.40 +.13		.500 -.002
	12.69 -.05		.501 +.006
ANGULAR	12.70 +.15	ANGULAR	.750 -.002
±1/2 °	19.09 -.05		.751 +.008
	19.10 +.20		1.000 -.003
	25.39 -.08		1.001 +.010
	25.40 +.25		OVER -.004
	OVER -.10		

ALL DIMENSIONS	COSMETIC APPEARANCE
mm[INCH]	MAX CLASS
THIRD ANGLE PROJECTION	A B
	MIN CLASS
DESIGN AUTHORITY	MATERIAL
WARWICK	FINISH
	4 5

APPROVALS	DATE
DESIGNED BY:	03/06/06
DRAWN BY:	03/06/06
CHECKED BY:	03/06/06
RESPONSIBLE ENG:	03/06/06
PROJECT/CUSTOMER:	
FILE NAME	20849-129

Schroff ...a brand of		Pentair Electronic Packaging	
TITLE			
KIT AMC MODULE FULL SIZE SINGLE 3 RECTANGULAR LIGHTPIPES			
SIZE	CAGE CODE	DWG NO.	REV
D62559		20849-129	
SCALE	2.000	WEIGHT:	N/A
			1 OF 2

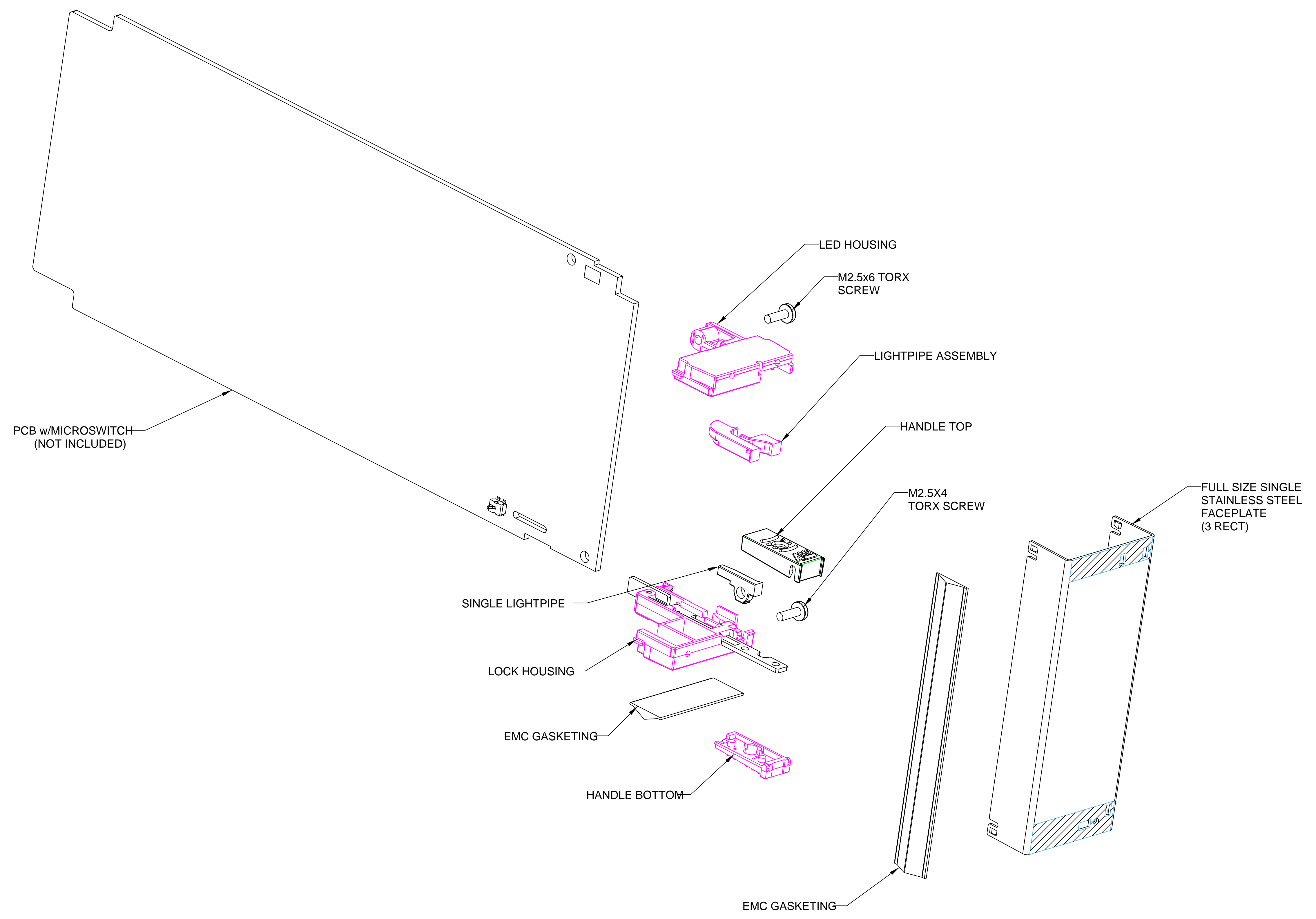

PCB w/MICROSWITCH
(NOT INCLUDED)

LED HOUSING

M2.5x6 TORX
SCREW

LIGHTPIPE ASSEMBLY

HANDLE TOP

M2.5x4
TORX SCREW

FULL SIZE SINGLE
STAINLESS STEEL
FACEPLATE
(3 RECT)

SINGLE LIGHTPIPE

LOCK HOUSING

EMC GASKETING

HANDLE BOTTOM

EMC GASKETING