

DWG NO	20849-128	REV	SH	1 OF 2
THIS DOCUMENT CONTAINS PROPRIETARY INFORMATION WHICH MAY NOT BE DISCLOSED TO OTHERS, REPRODUCED OR USED WITHOUT AUTHORITY FROM THE PROPRIETOR.				
REVISION HISTORY				
REV	DESCRIPTION	INC BY	DATE	APPROVED
A	--/-- EDR		--/--	

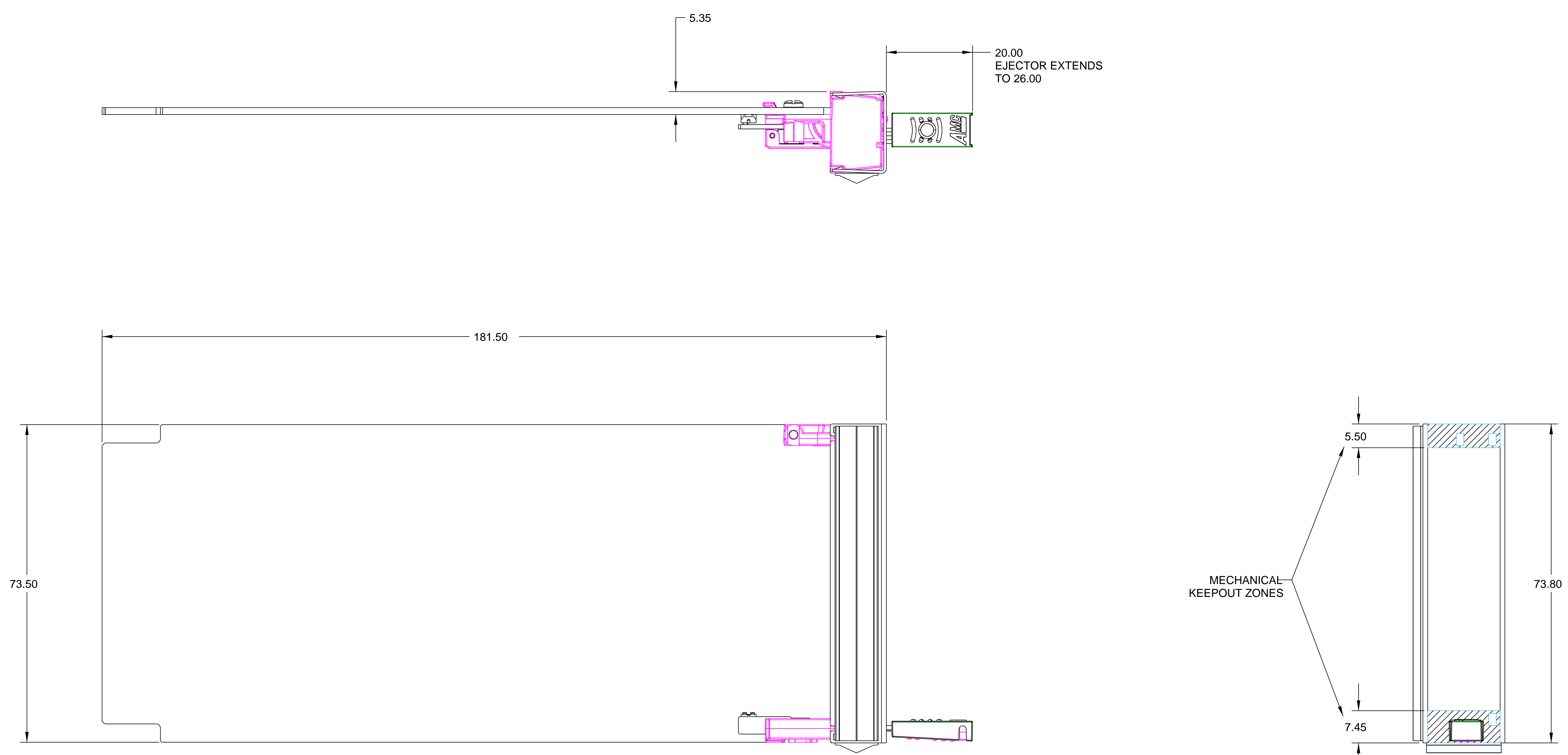

P/N 20849-128 FURNISHED AS A KIT
PCB w/MICROSWITCH NOT INCLUDED

TOLERANCE (UNLESS OTHERWISE SPECIFIED)			
mm	HOLES	[INCH]	HOLES
DECIMALS	0.00 +.08	DECIMALS	0.000 +.003
X	3.19 -.03	X.XX ±0.02	.124 -.001
X.X	3.20 +.10	X.XXX ±0.010	.125 +.004
X.XX	6.39 -.03		.250 -.001
	6.40 +.13		.251 +.005
	12.89 -.05		.500 -.002
	12.70 +.15		.501 +.006
	19.09 -.05		.750 -.002
	19.10 +.20		.751 +.008
	25.39 -.08		1.000 -.003
	25.40 +.25		1.001 +.010
	OVER -.10		OVER -.004
ANGULAR	±1/2 °	ANGULAR	±1/2 °

ALL DIMENSIONS	COSMETIC APPEARANCE
mm[INCH]	MAX CLASS
THIRD ANGLE PROJECTION	A B
DESIGN AUTHORITY	MIN CLASS
WARWICK	MATERIAL FINISH
	4 5

APPROVALS	DATE
DESIGNED BY:	03/06/06
DRAWN BY:	03/06/06
CHECKED BY:	03/06/06
RESPONSIBLE ENG:	03/06/06
PROJECT/CUSTOMER:	
FILE NAME	20849-128

TITLE	
KIT AMC MODULE MID SIZE SINGLE 3 RECTANGULAR LIGHTPIPES	
SIZE	CAGE CODE
D62559	20849-128
DWG NO.	REV
20849-128	1 OF 2
SCALE	WEIGHT
2.000	N/A

DO NOT SCALE DRAWING

CUSTOMER PART NO.	REV

10

9

8

7

6

5

4

3

DWG NO
20849-128

REV SH
2 OF 2

1

F

F

E

E

D

D

C

C

B

B

A

A

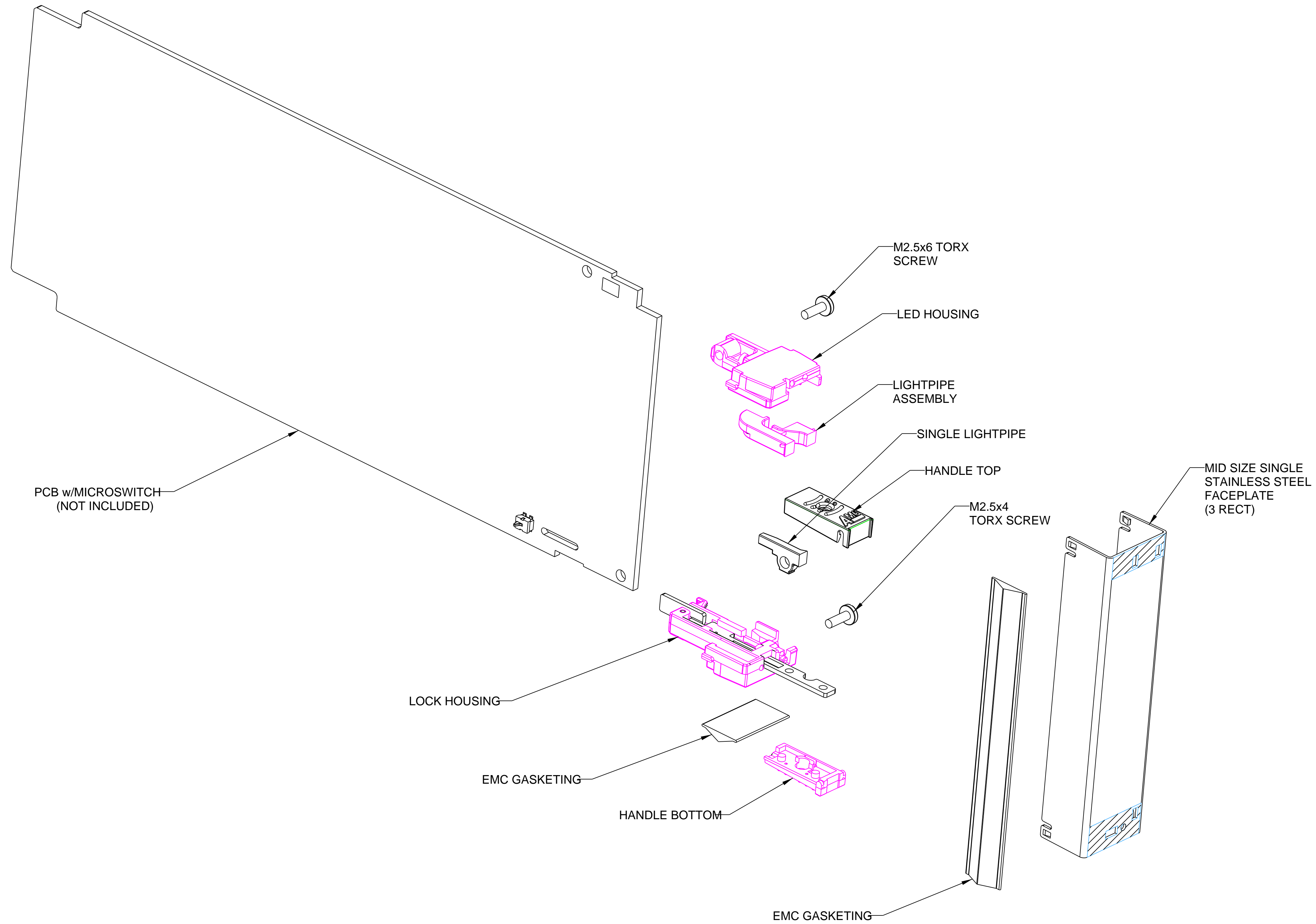

10

9

8

7

6

5

4

3

2

1